



*Institute for Innovation
and Improvement*

Hard Work and Vigilance: Necessary but Insufficient

The Role of Human Factors in General
Practice

Dr Richard Jenkins

Tuesday 21st September 2009



Sit up, pay attention:

NHS

*Institute for Innovation
and Improvement*





*Institute for Innovation
and Improvement*

The Amazing Colour Changing Card Trick

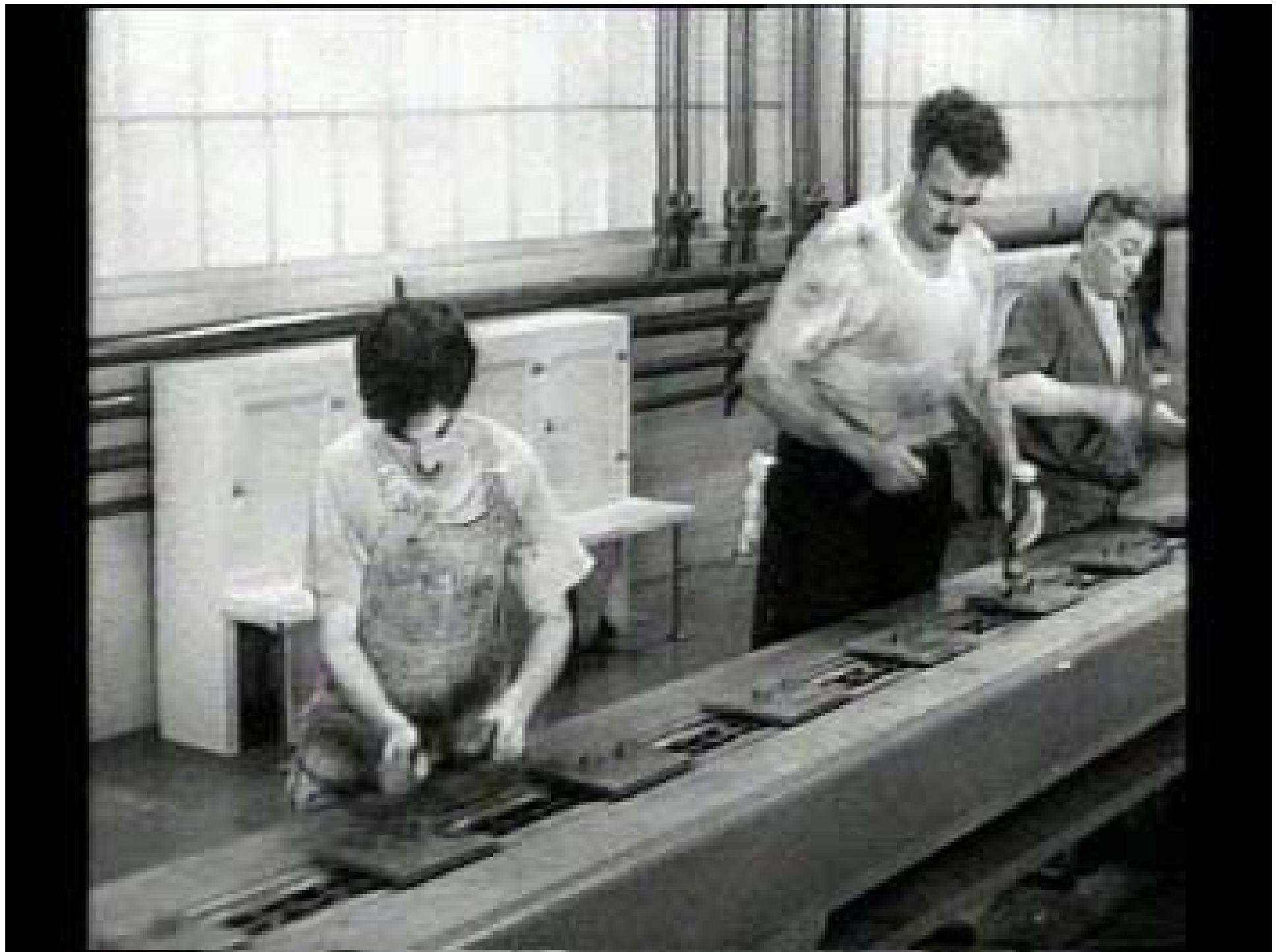



Errors



*Institute for Innovation
and Improvement*

1. Errors are common
2. The causes of errors are known
3. Errors are by-products of useful cognitive functions
4. Many errors are caused by activities that rely on weak aspects of cognition
5. Errors can be prevented by designing tasks and processes that minimize dependence on weak cognitive functions
6. Systems failures are the “root causes” of most errors

Lucian Leape, “Error in Medicine” *JAMA*, 1994



*Institute for Innovation
and Improvement*

“We can’t change the human condition,
but we can change the conditions
under which humans work”

James Reason



A systems perspective

From Vincent et al

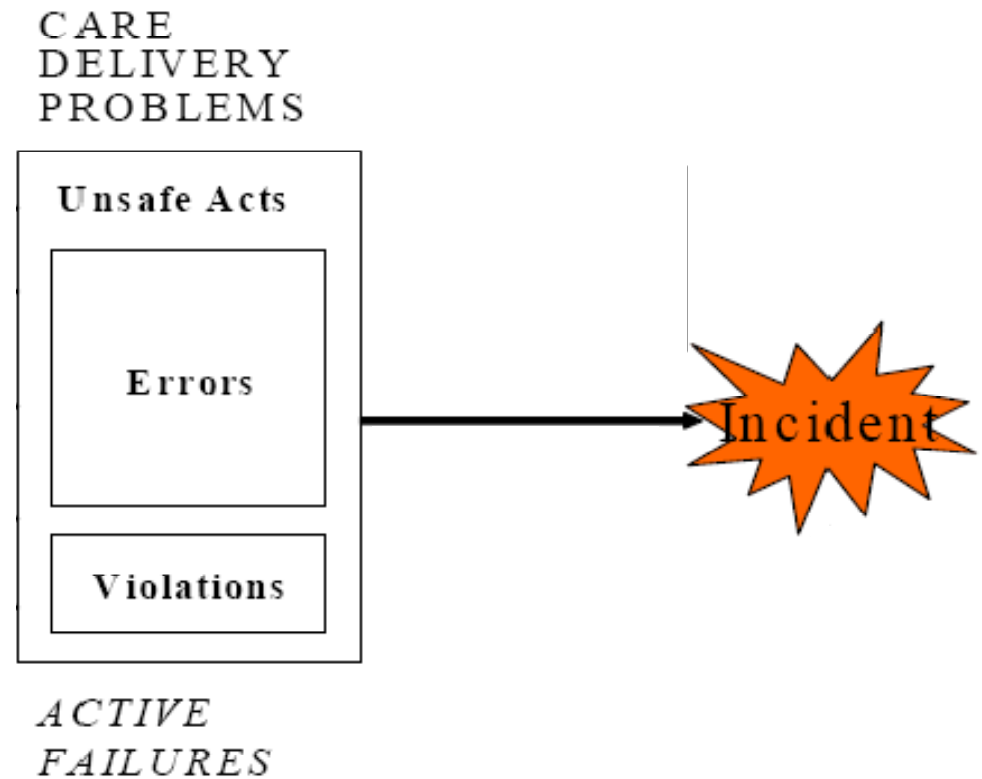



Personal & environmental factors

From Vincent et al

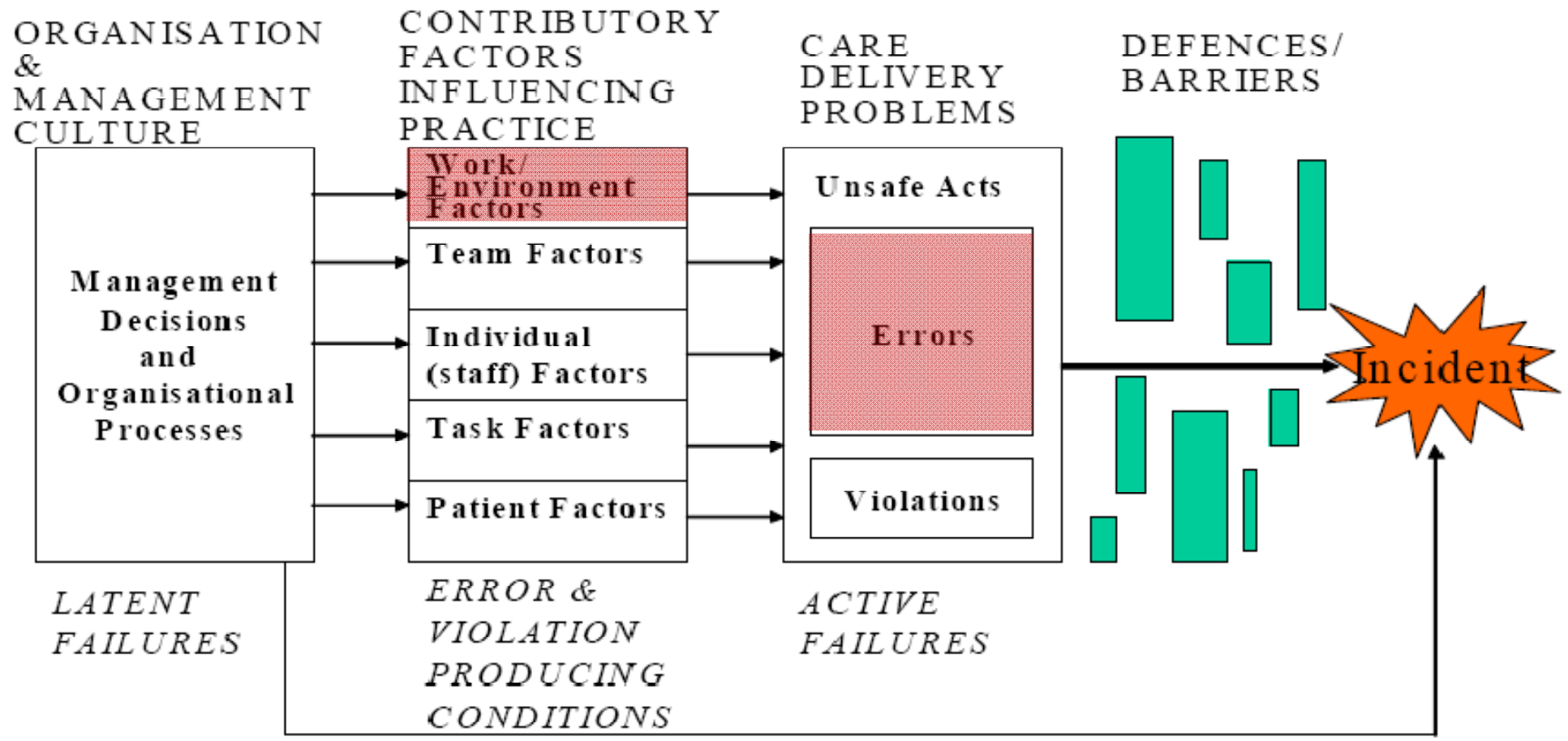



Personal & environmental factors



*Institute for Innovation
and Improvement*

Personal Factors

Fatigue

Lack of sleep

Illness

Irregular work patterns

Drugs or alcohol

Boredom

Frustration

Fear

Shift work

Reliance on memory

Reliance on vigilance

Environmental Factors

Distractions

– Noise

– Heat

– Clutter

– Motion

– Lighting

Too many handovers

– Unnatural workflow

Poorly designed procedures or devices

Inadequate training and skills



Human factors engineering

Examines a particular activity in terms of its component tasks and then considers each task in terms of:

physical demands,
skill demands,
mental workload and other
such factors

adequate lighting,
limited noise, or other
distractions
device design, and
team dynamics

p4

Awaiting better definition from Mark AS

nc2400 User, 27/06/2008



'Three bucket' model for assessing risky situations (Reason, 2004)

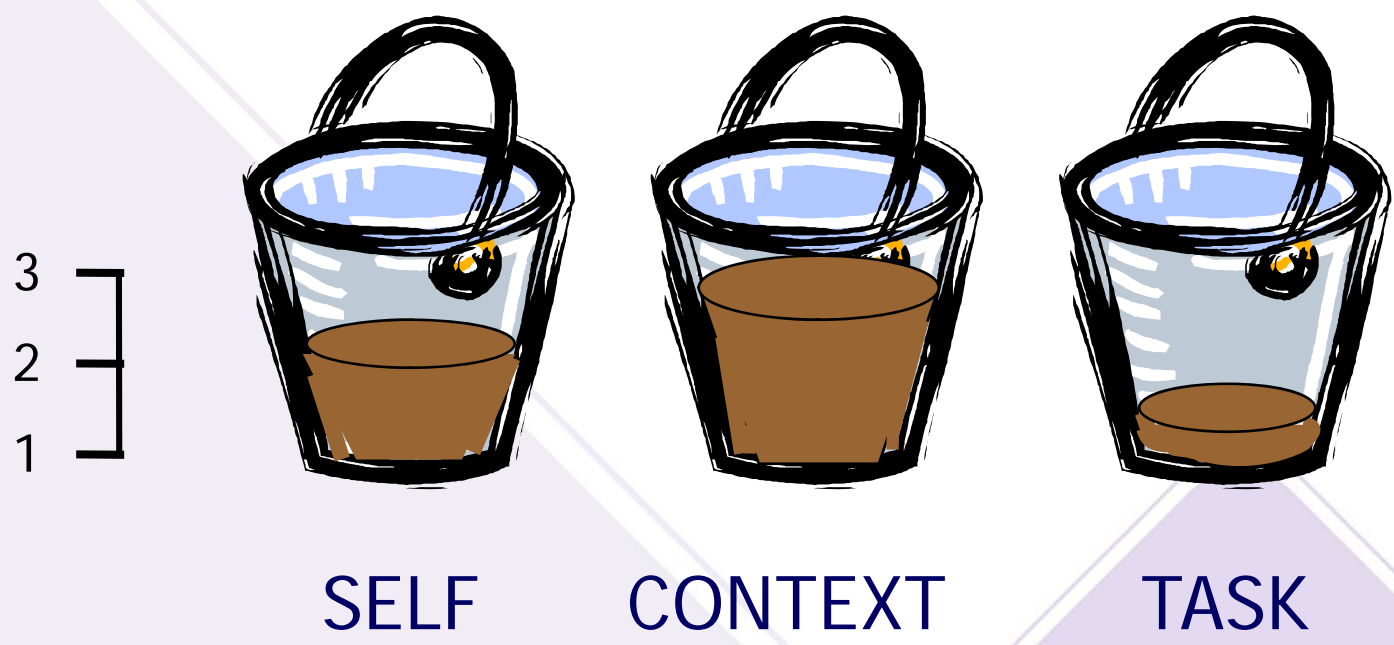

The fuller your buckets, the more likely something will go wrong ... but your buckets are never empty.



What impacts our performance?



*Institute for Innovation
and Improvement*

1. What we think

- Overloading our cognitive state

2. What we do

- Overloading our behavioural repertoire

3. What we feel

- Overloading our emotional state

- Overestimate abilities
- Underestimate limitations
- Noise
- Distractions
- Environmental conditions
- External stimuli
- Internal response to stress
- Release of stress hormones
- Anxiety
- Increased heart rate



*Institute for Innovation
and Improvement*

Error reduction strategies



Error reduction strategies



*Institute for Innovation
and Improvement*

Design for safety

avoid setting yourself up to fail

1. The way we think – (cognition strategies)

- Avoid reliance on memory
- Simplify
- Standardise
- Safer labels and signs

2. The things we do – (behavioural strategies)

- Use constraints/forcing functions
- Use protocols and checklists
- Improve information access

3. The way we feel about our work – (emotional strategies)

- Promote effective team functioning
- Reduce number of handovers
- Structured management of handovers



Design for safety



*Institute for Innovation
and Improvement*





Design for safety

NHS

*Institute for Innovation
and Improvement*





Design for safety

NHS

*Institute for Innovation
and Improvement*

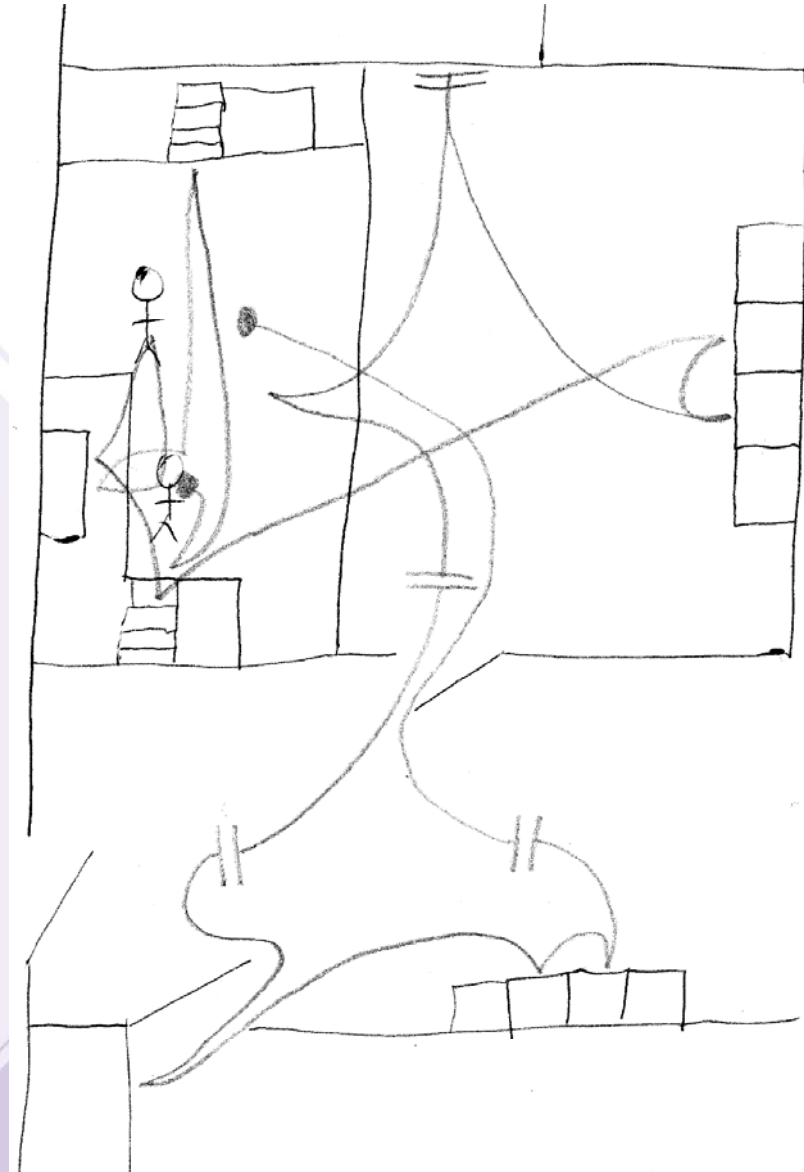



Design for safety

NHS

*Institute for Innovation
and Improvement*



Valoid™ injection
 cyclizine lactate

50mg in 1ml
 5 x 1ml ampoules

POM

 Wellcome

ANTI-EMETIC

OPEN HERE 

Vasoxine™
 Injection
 Methoxamine
 Hydrochloride BP
 20mg in 1ml

POM

5 x 1ml ampoules

GlaxoWellcome

PRESSOR AGENT

OPEN HERE 



POM 10 Ampoules
 5 ml

WATER FOR INJECTIONS BP

Each 5 ml contains water for injections EP to 100% w/v
 A sterile solution for IM, IV or SC injection

USE AS DIRECTED BY A PHYSICIAN
KEEP OUT OF THE REACH OF CHILDREN

Store at less than 25°C.
 Inactive Ingredients: None
 P.L. Number: 1502/0003 R
 P.L. HOLDER

PHOENIX PHARMA LTD.

levum Works, Upton Street, Gloucester, GL1 4LA



POM 10 ampoules
 5 ml

LIDOCAINE HYDROCHLORIDE INJECTION BP
 1% w/v

Each 5ml contains 50mg Lidocaine Hydrochloride EP
 in Water for Injections EP

USE AS DIRECTED BY A PHYSICIAN
 For subcutaneous, intramuscular or intravenous injection
 For further information see enclosed leaflet
 Store at less than 25°C and protect from light.
 If only part used please discard remainder.

KEEP OUT OF THE REACH OF CHILDREN

PL NUMBER 1502/0002 R
 PL HOLDER

PHOENIX PHARMA LTD.

Unit 5, Glevum Works GLOUCESTER GL1 4LA

Frisium® Tablets 10 mg
 Clobazam

Anxiolytic

30 tablets

 Hoechst Marion Roussel

Clomid® 50mg
 Clomifene Citrate BP

30 Tablets

 Hoechst Marion Roussel



Assess your environment



*Institute for Innovation
and Improvement*

Conduct review of organization

- Are processes simple and standardized?
- Are failure identification and mitigation systems in place?

Conduct a task analysis

- How many interruptions are there during the work shift?
- How complex are the tasks or instructions?

Conduct human factors audits

- Noise levels; distractions; design of workspace; label format; work hours and reviews

Train staff in human factors awareness



*Institute for Innovation
and Improvement*

www.institute.nhs.uk/safercare/GP