

**Bournemouth  
University**



# BSc (Hons) Midwifery

**Department of Midwifery and Health Sciences**

## Why study Midwifery at BU?

- Degree course - BSc (Hons) with Nursing and Midwifery Council registration
- Respected course, one of the first UK universities to run direct entry Midwifery
- Two teaching sites and seven NHS Trusts
- Pioneered Caseloading for students in the UK
- 2021 curriculum is already running and meets NMC standards (2019 & 2023)



## Why study Midwifery at BU?

- UNICEF Baby Friendly Initiative (BFI) accreditation since 2011, Gold Award for sustainability in 2021.
- Many years of experience teaching Examination of the Newborn (EXON)... now part of new NMC Standards.
- Department links to BU Research Centre for Midwifery and Womens' Health, led by Professors.





- Very high level of employment as on qualification
- Students go on to work in Midwifery posts in the local area and across the UK
- Many go on to specialist roles, such as Infant Feeding Lead, Screening Midwife, Safeguarding and Young Person's Midwife
- Opportunities in research and education



## Two locations

### Study in Bournemouth



### Study in Portsmouth



Please see [www.bournemouth.ac.uk/courses](http://www.bournemouth.ac.uk/courses) for the latest information about this course.



# The academic year

45 weeks of study with  
set holidays:

Christmas (2 weeks)

Spring (2 weeks)

Summer (3 weeks)



## Curriculum themes

The course has been developed using evidence from the Lancet Midwifery Series to meet the NMC 2019 Midwifery Standards

The curriculum is arranged in five broad recurring themes which reflect key aspects of midwifery care.

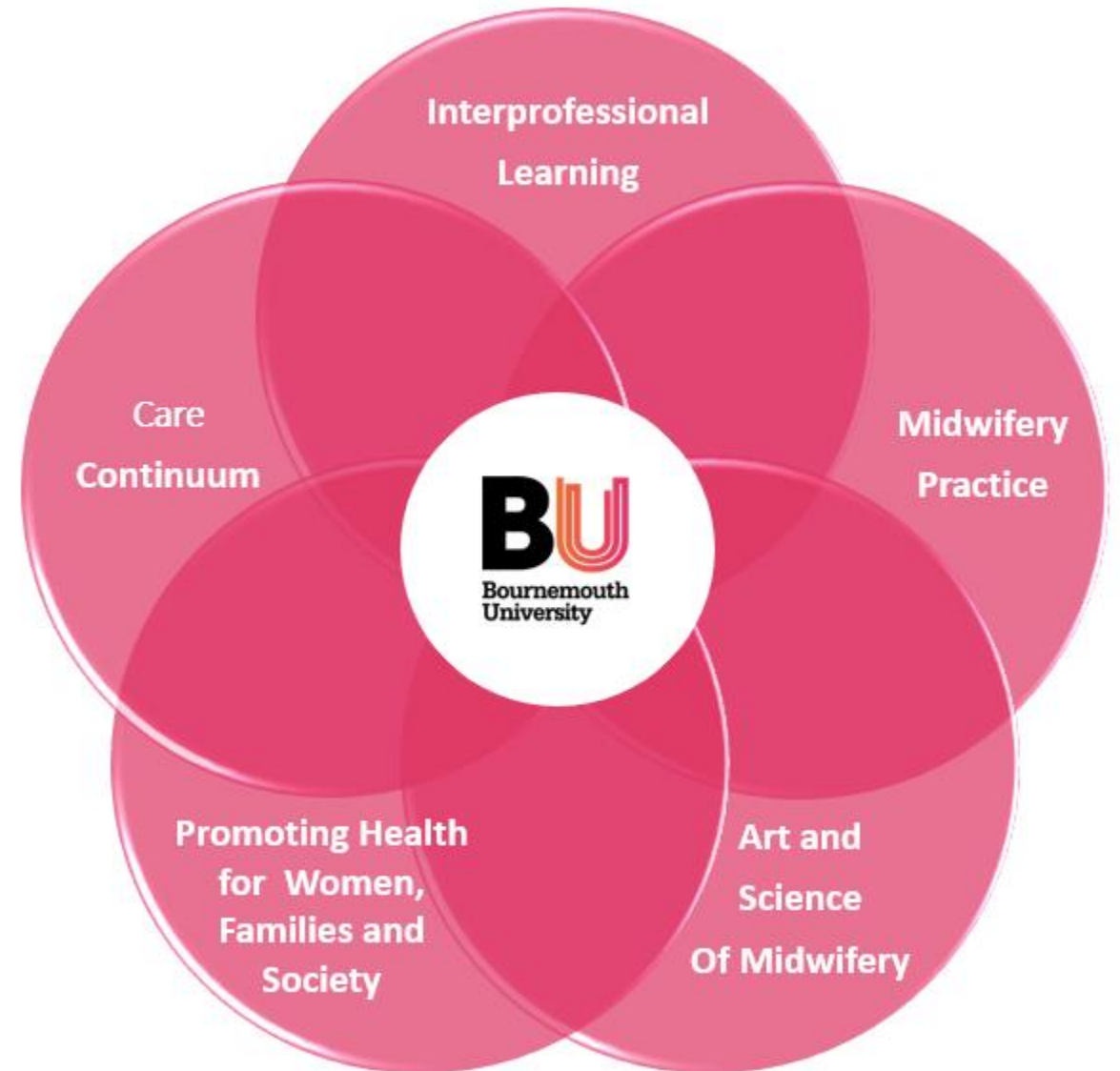

# Course content

Year 1 (Level 4)	Year 2 (Level 5)	Final Year (Level 6)
Midwifery Practice 1A	Midwifery Practice 2A	Midwifery Practice 3A
Midwifery Practice 1B	Midwifery Practice 2B	Midwifery Practice 3B
Childbirth Journeys	Medicines Optimisation and the Midwife	Evidence for Midwifery Practice
Fundamental Midwifery Care	Complexities in Midwifery Care	Care in Midwifery Emergencies
Promoting Health	Local, National and Global Health	Leadership and Innovation in Midwifery Care
Foundations for Professional Practice and Research	Research for Professional Practice	Team Working for Service Improvement



# Where do students undertake clinical placements?

Usually around 80 students per year group

## Bournemouth Campus Placements:

- Poole/Bournemouth (University Hospitals Dorset)
- Salisbury
- Dorchester
- Yeovil

## Portsmouth Campus Placements:

- Portsmouth
- Winchester
- Isle of Wight

We have a range of birth centres in our linked Trusts...plus student led clinics linked to BU

## Practice experience

Midwifery students gain a wealth of experience in practice in

- Community, intrapartum, postnatal, antenatal and a variety of clinics
- Continuity teams
- Integrated care
- Promoting health visits, women's health, neonatal care and leadership visits





## Practice experience

- Midwifery students are assigned to one NHS Trust for the majority of the course
- With at least one additional short placement in an alternative Trust
- Students supported by midwifery Practice Supervisors in each practice location and assessed by their Practice Assessor
- Students and staff in each Trust are supported by two or more Link Tutors from the academic team at BU



# Facilities at Bournemouth University

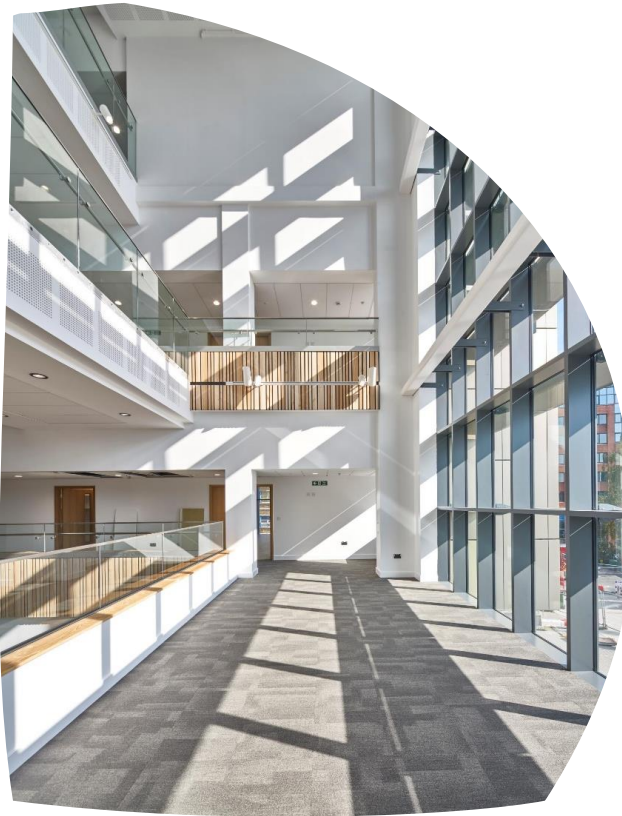



# Bournemouth Gateway Building

- £42m investment, built in 2020
- Home to Bournemouth University's Faculty of Health & Social Sciences
- 10,000m<sup>2</sup> of space creates a unified base for the faculty's education and research endeavors
- Provides access to the latest in education technology and specialist equipment including; a maternity birthing suite, operating theatre and simulation skills labs



- Smaller and more intimate campus set on the 4<sup>th</sup> floor of St Mary's hospital in Portsmouth
- Dedicated teaching environment with two seminar rooms, IT suite and practice simulation suite
- Reduced travel requirement for students not as local to Bournemouth
- Access to BU facilities





Living in your home/ accommodation near your practice site

**Or**

Living in your home/accommodation/halls of residence and taking temporary accommodation near your practice site

[www.bournemouth.ac.uk/accommodation-hss](http://www.bournemouth.ac.uk/accommodation-hss)

Please make sure you look into NHS practice placement expenses to find what you are entitled to



## How we look after you

- **Academic**

- Year Tutor, Personal Tutor, Programme Leaders,
- Lead Midwife for Education
- Additional Learning Services
- Academic skills workshops

- **Practice**[object File]

- Professional Midwifery Advocates (PMA)
- Link Tutor visits

- **Peer**

- Student Midwifery Council
- Peer Academic Learning Support (PALS)

- **Pastoral Support**

- Academic and practice links
- Counselling service, Health and Wellbeing, Achieve, Students' Union (SUBU) and Faith & Reflection





Providing exciting and stimulating extracurricular events to bring all year groups together across all locations

- Talks by international speakers and local groups
- Workshops
- Visits and Socials



Follow on Instagram  
**@bumidwiferysoc**

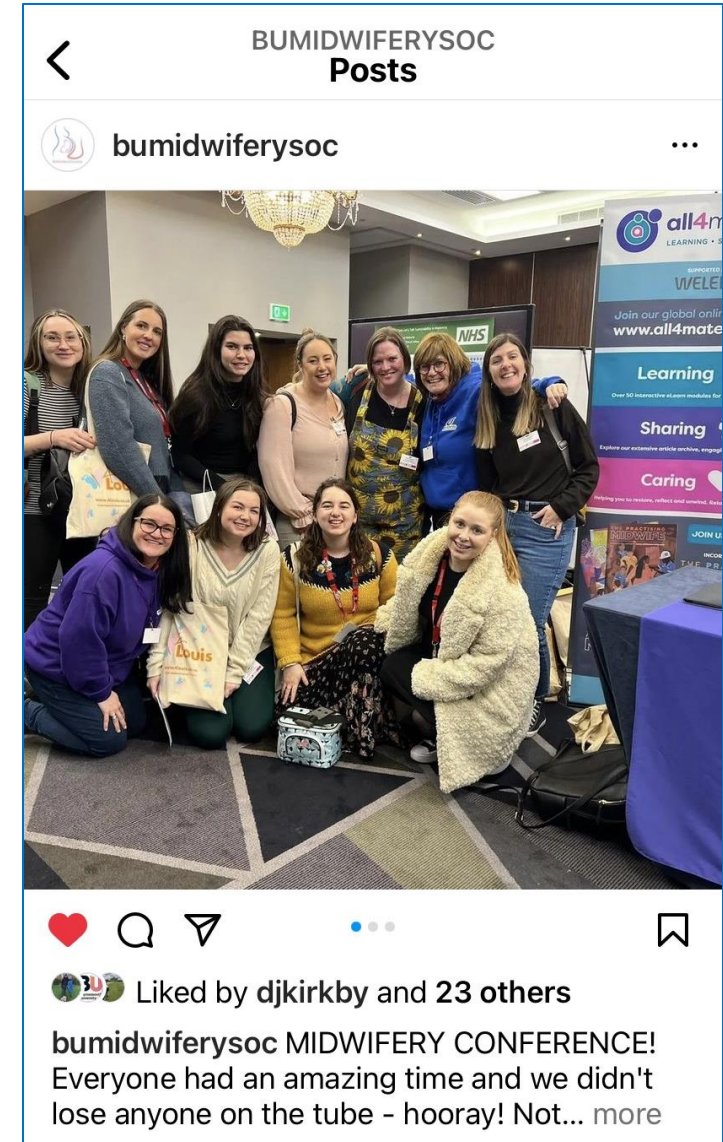

## Our lasting impression... *What do our graduates say?*

Great support from my  
Personal Tutor

I have thoroughly  
enjoyed my time on  
this course, I have  
learnt so much and  
met some friends that  
will last a lifetime.

I enjoyed the range of  
different types of  
assessments - e.g.,  
essays, OSCE,  
discussions.

The best lectures are those that  
are interactive and practical.  
Breastfeeding teaching is  
superb! Lecturers are positive,  
passionate and inspirational.

Placement has helped my own professional development with  
my confidence and communication. Furthermore, my  
knowledge has expanded massively and I have learnt a lot  
which has in turn helped me in practice.



**In communities everywhere, it's a basic human right of every single woman, baby and family to experience the best and safest care possible during pregnancy, birth and postnatally.**

The Nursing and Midwifery Council, 2020



**Bournemouth  
University**



Please note: The detail, dates and additional fees stated are correct at the time of presenting. The latest information can be found at [www.bournemouth.ac.uk/courses](http://www.bournemouth.ac.uk/courses).

**Questions? We've got answers.**  
**01202 961916**  
**futurestudents@bournemouth.ac.uk**

**Instagram**  
**@hss\_bu**